

Town of Pelham User Fees and Charges

2025



Overview

An experience at a summer camp or swim program,
a requirement to obtain duplicate billing information or
a new beginning obtaining a house permit,
all of these experiences and more are realized within
this guide.

User fees and charges are established to ensure that services specific to individuals are not subsidized by all ratepayers within the Town of Pelham.

The Town of Pelham is proud to offer the experiences outlined in this guide at a minimal cost to the community members that require them.

The user fees and charges outlined in this document are regulated by By-law 88 - 2024.

Disclaimer

Where it is found that a fee in this schedule is different than an approved bylaw or policy, the latter shall prevail.

All fees and charges do not include applicable taxes. Where fees and charges are subject to taxes, they will be added at point of sale.

Contact

For more information about content found within this guide, please contact:



Index



Clerk's Department



Corporate Services



Fire & By-Law Services



Planning & Development Services



Recreation & Cultural



Public Works

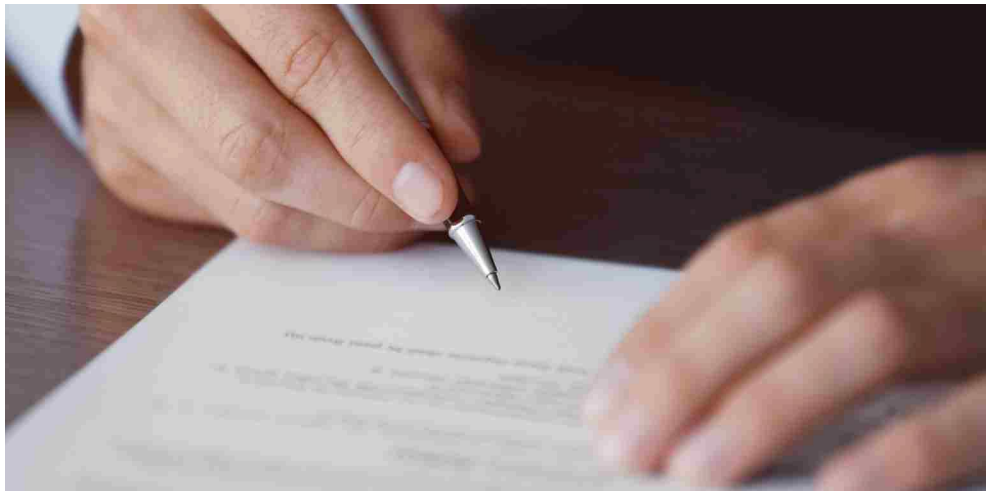

Clerk's Department

	2025
Business Licensing	
Annual Vendor License	\$250.00
Limited Vendor License	\$25.00
Bed and Breakfast, Fee Per Bedroom	\$150.00
Short Term Accommodation, Fee Per Bedroom	\$300.00
Affidavits /Commissioner of Oath	
Signature for all documents	\$20.00
Non-resident Signature for all documents	\$30.00
Registrar Statement/Travel Letter	\$20.00
Burial Permits/Death Registrations	\$20.00
Burial Permits/Death Registrations – After hours	\$100.00
Photocopies per page	\$0.30
Retrieval of Archived Records from Off-Site Storage	\$20.00
Lottery Licensing	
Bingo License % of prizes not exceeding \$5,500.00	3%
Raffle Lotteries % of prizes not exceeding \$50,000.00	3%
Bazaar Lotteries % of prizes not exceeding \$500.00	3%
Bazaar Lotteries – per wheel	\$10.00
Break Open Ticket (Nevada) Lottery % of prizes each occasion	3%
Break Open Ticket (Nevada) Lottery Home Base % of total prizes	2.25%
Line Fences Administrative Fee	\$425.00
Muzzle Order Appeal Hearing Fee	\$275.00



Clerk's Department

		2025
Marriage Licensing		
License Fee		\$130.00
Ceremony Fee – On Site – Business Hours*		\$200.00
Rental of Peace Park Bandshell applies		\$27.00
*Rental Fee – Town Hall Council Chambers p/hr		\$25.00
*Rental Fee – Business Hours – MCC Accursi Lounge (25 people) p/hr		\$27.00
*Rental Fee – Business Hours – MCC ½ Accursi (50 people) p/hr		\$37.00 \$53.50
Ceremony Fee – Off Site and After Hours (Plus Expenses)		\$300.00
Rehearsal Fee		\$75.00
Witness Fee – Municipal Staff – Normal Business Hours – Each		\$25.00
Cleaning Fees, if required		\$100.00
Municipal Property Damage – Billable		Full Cost Recovery
Note 1: For weddings not officiated by the Town of Pelham, separate MCC Rental Fees and requirements apply.		
Temporary Outdoor Patio on Municipal Property Permit		\$150.00
Freedom of Information		
Application Fee		\$5.00
Photocopies – per page		\$0.20
Manual search, each 15 minutes		\$7.50
Preparation of record for disclosure – each 15 minutes		\$7.50
Retrieval of Archived Records in Off-Site Storage		\$20.00

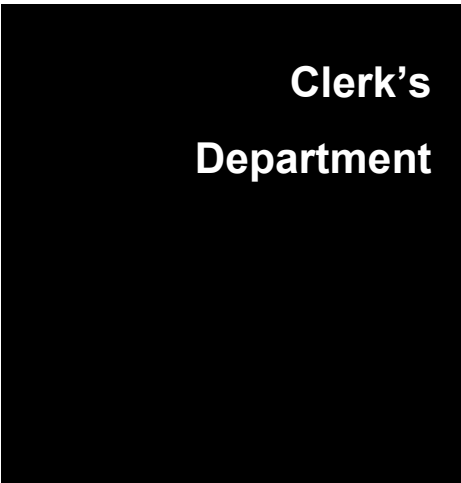

	2025
Integrity Commissioner Complaint Filing Fee(s) *Per Term of	
First Complaint	No Fee
Second Complaint	\$100.00
Three or More Complaints	\$300.00
*Please contact the Clerks Department for applicable exemptions	



Corporate Services

		2025
General Tax Services Fees		
Statement of Tax Account		\$10.00
Reprint of Tax Bill		\$10.00
Tax Certificate – Mailed		\$55.00
Tax Certificate – Verbal		\$25.00
Interest and Penalty on Tax Arrears		1.25%
NSF Charge		\$35.00
New Roll Creation		\$40.00
Ownership Change		\$40.00
Mortgage Company Administration Fee		\$15.00
Tax Registration Fees		
Tax Registration		Actual fees charged plus 25%
After Final Notice		Actual fees charged plus 25%
Sale by Tender/Auction		\$2,200.00
Preparation of Extension Agreement		\$500.00
POA add to taxes		\$50.00
General Accounts Receivable		
Interest on Accounts Receivable		1.25%
NSF Charge on Accounts Receivable		\$35.00
Administrative Fee for Adding Arrears to Tax		\$30.00
S. 357/358 Application Fee		\$30.00



Fire & By-Law Services

	2025
Prevention, Protection and Inspection Fees	
File Search	\$75.00
Request for Reports/Copies	\$75.00
Photographs	\$10.00
Fireworks Permits	
Sales	\$100.00
Storage	\$100.00
Display	\$100.00
Fire Route Application	
Administration Fee	\$100.00
Residential Requests	
Mortgage Clearance	\$100.00
Change of Ownership	\$100.00
Multi Residential after two units (each)	\$25.00
Burn Permit (annual)	\$25.00
Burn Permit (new requiring an inspection)	\$50.00
Commercial & Industrial Requests	
First 2000 square meters	\$200.00
Each additional 100 square meters (each)	\$50.00
Tenant Space Individual (each)	\$50.00
L.L.B.O. Licenses Requests	
Premises	\$100.00



Fire & By-Law Services

	2025
Prevention, Protection and Inspection Fees (continued)	
Patio (each)	\$50.00
Special Occasions (each)	\$50.00
Hen License Application Fee	\$100.00
Hotels-Motels Requests	
1-10 units	\$200.00
Over 10 units (per unit)	\$10.00
Day Care Requests	
Day Nurseries/Home Day Care Licenses	\$150.00
Fire Safety Plans	
Approvals	\$100.00
Inspection for Trade Shows	
Home Shows/Special Functions	\$150.00
Installation of Rural 911 Sign	\$100.00
Issuance of Occupant	
Loads sign – 60 persons or less	\$50.00
Loads sign – 61 persons or more	\$100.00
Vacation Rental Inspection Fee	\$150.00
Accreditation Inspections	
Nursing Homes	\$150.00
Rest Homes	\$150.00
Seniors Apartments	\$150.00
Care Facilities	\$150.00



Fire & By-Law Services

		2025
Prevention, Protection and Inspection Fees (continued)		
Fire Drills		
Fire drill observation by (an) inspector(s) assigned by the chief fire official of any subsequent fire drill within the same calendar year		\$500.00
Municipal Property Damage		Full Cost Recovery
Discretionary Fees		
Equipment, Labour and/or Materials used at an incident		Full Cost Recovery
False Alarm Response		
Per hour per Fire Department Vehicle		\$580.00
Per additional ½ hour per Fire Department Vehicle		\$290.00
<i>Note: False Alarm Fees will only be implemented when it is determined by the Fire Chief that the false alarm was preventable or the fire alarm system was improperly installed, maintained or resulted from a malicious act by an individual. See By-Law 3085(2010) for details.</i>		
Response to an unauthorized Open Air Burn		
Per hour per Fire Department Vehicle		\$550.00
Per additional ½ hour per Fire Department Vehicle		\$275.00
Motor Vehicle Fires and Collisions – Non-Resident		
Per hour per Fire Department Vehicle		\$550.00
Per additional ½ hour per Fire Department Vehicle		\$275.00
Fail to Comply with an Ontario Regulation causing an Emergency Response OR 210/01		



Fire & By-Law Services

	2025
Response to an unauthorized Open Air Burn (Continued)	
Per hour per Fire Department Vehicle	\$550.00
Per additional ½ hour per Fire Department Vehicle	\$275.00
Note: Motor Vehicle fires and Collisions – Non-Resident MAY be charged where the Pelham Fire Department has responded to an emergency situation, including motor vehicle accidents and fire, in which a non-resident person is involved.	
Sign Fees	
Ground Signs up to 50 square feet	\$100.00
Ground Signs over 50 square feet	\$150.00
Menu Board Signs	\$150.00
Mobile Signs with Modifiable Copy	\$100.00
Pole Signs	\$150.00
Projecting Signs	\$150.00
Roof Signs	\$150.00
Temporary Signs	\$100.00
Wall Signs	\$100.00
Signs Exceeding Sign Face Area or Height Requirements	\$150.00
Applications and Permits for Signs requiring Council Approval	
Applications to Council for Variance	\$250.00
Property Standards & Clean Yard (default not remedied)	
Administrative Fee	\$200.00



Fire & By-Law Services

	2025
Property Standards & Clean Yard (default not remedied) Continued	
Initial Inspection Fee	\$100.00
Re-Inspection Fee	\$100.00
Mailing Fee	\$30.00
Remedial Action taken to correct default (total cost)	+ 30%
Notice to comply	\$95.00
Fencing	
Application to Council for Fencing Variance	\$150.00
Kennel License	\$100.00
Notice to comply (all by-laws)	\$95.00
Municipal Orders (all by-laws)	\$110.00



Planning & Development Services

	2025	Fees effective Sept.1, 2025
Planning Fees		
Pre-Consultation Meetings		
Minor Pre-Consultation (Zoning/ Official Plan Amendments & Site Plan Control)	\$250.00	
Major Pre-Consultation (Subdivision, Condominiums)	\$500.00	
No pre-consultation fees are required for Committee of Adjustment Applications, including Consents and Minor Variances or On-Farm Diversified Uses.		
Committee of Adjustment Applications		
Consent	\$1,688.00	\$3,672.00
Each additional lot after the first (limit of 3 in addition to the retained for a total of 4 lots)		\$847.00
Request for Change in Conditions	\$620.00	\$1500.00
Rescheduling Fee	\$283.00	\$362.00
Final Certifications	\$445.00	
Recirculation Due to Change in Application	\$283.00	
Special Hearing Fee (In Addition to Application Fee)	\$620.00	\$796.00
Cancel Consent Application Fee	\$432.00	
Cancel Consent Certificate Fee	\$108.00	
Rescheduling Fee	\$283.00	\$362.00
Final Certification	\$445.00	
Minor Variance – Simple *CPD Director Discretion	\$1,237.00	\$1,800.00
Minor Variance – Complex	\$1,237.00	\$3,300.00
Rescheduling Fee	\$283.00	\$362.00

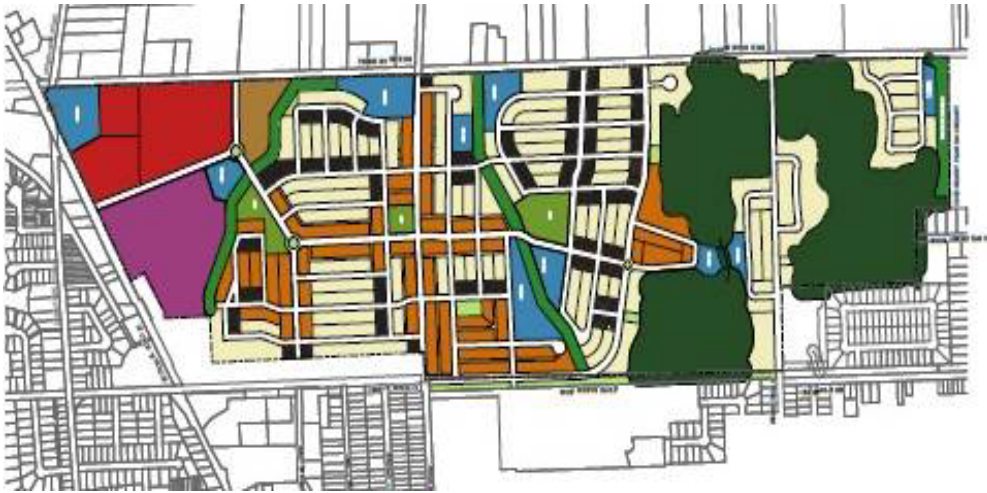

Planning & Development Services

Planning Fees (continued)	2025	Fees effective Sept. 1, 2025
Recirculation Due to Change in Application	\$283.00	
Special Hearing Fee (In Addition to Application Fee)	\$620.00	\$796.00
Recirculation Due to Change in Application	\$283.00	
Zoning By-Law Amendment	\$5,056.00	\$13,012.00
Minor Zoning By-Law Amendment *CPD Director Discretion	\$3,162.00	\$7,372.00
Official Plan Amendment	\$6,318.00	\$13,538.00
Combined Zoning By-Law & Official Plan Amendment	\$10,110.00	\$15,183.00
Site Plan Control Applications		
Site Plan Approval – Minor (Building addition <100 m ² , etc.) **Note: Separate fee for the agreement	\$1,254.00	\$1,544.00
Site Plan Approval – Standard **Note: Separate fee for the agreement	\$4,423.00	\$5,447.00
Site Plan Approval – Complex (extension of municipal services) **Note: Separate fee for the agreement	\$4,423.00	\$6,368.00
Resubmission of Site Plan Prior to Approval	\$897.00	
Site Plan Amendment Note: Separate fee for the agreement	\$3,162.00	\$3,379.00
Release of Site Plan Agreement	\$1,140.00	\$1,174.00
Plan of Subdivision & Condominium Applications		
Draft Plan of Subdivision	\$10,110.00	\$10,713.00
Resubmission of Draft Plan Prior to Approval	\$1,194.00	\$1,325.00
Modification to Draft Plan of Subdivision	\$6,318.00	\$10,713.00

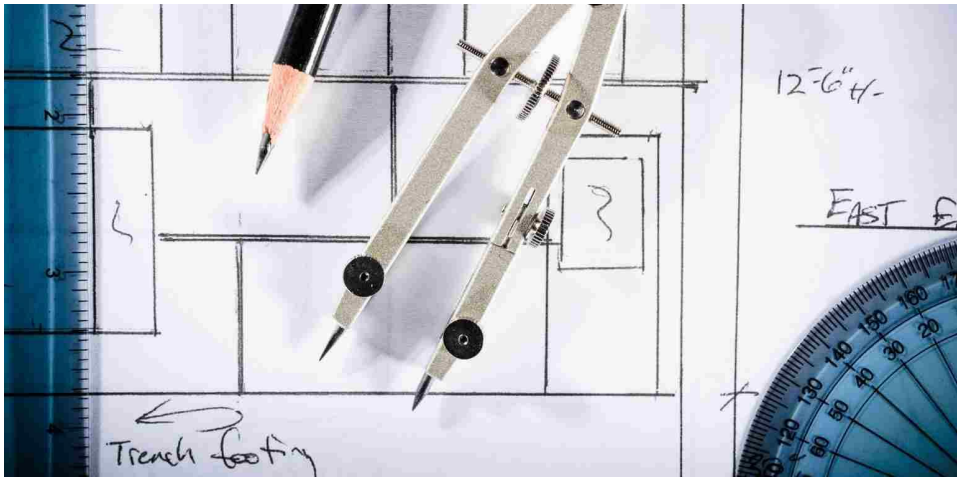

Planning & Development Services

Planning Fees (continued)

	2025	Fees effective Sept. 1, 2025
Extension to Approval of a Draft Plan of Subdivision	\$1,012.00	\$2,031.00
Final Approval of Draft Plan of Subdivision	\$1,897.00	\$2,000.00
Draft Plan of Condominium	\$5,056.00	\$16,652.00
Resubmission of Draft Plan of Condominium Prior to Approval	\$1,194.00	\$317.00
Modification to Approval of a Draft Plan of Condominium	\$2,529.00	\$15,365.00
Extension to Approval of a Draft Plan of Condominium	\$1,012.00	\$1,884.00
Condominium Exemption		673.00

Agreements

Subdivision Agreements, Site Plan Agreements, and Development Agreements requiring the extension of municipal services		
\$12,147.00 where the cost of construction of all work is less than \$100,000.00		
\$12,147.00 plus 4.0% of the costs between \$100,00.00 and \$400,000.00		
\$26,383.00 plus 3.5% of the costs exceeding \$400,00.00		
Amendment to a Subdivision Agreement	\$950.00	\$4,282.00
Site Plan Agreements and Development Agreements where municipal services are not required to be extended	\$3,038.00	\$3,741.00
Amendment to Development Agreement	\$950.00	
Release of Development Agreement	\$1,140.00	
Condominium Agreement	\$3,038.00	\$3,249.00
Amendment to Condominium Agreement	\$950.00	\$4,282.00



Development Planning & Services

Planning Fees (Continued)	2025	Fees effective Sept.1, 2025
Minor Agreement (Garden Suite / Environmental / EIS)	\$,1827.00	\$1,827.00
Encroachment Agreement	\$352.00	\$1474.00
Temporary Primary Dwelling Agreements	\$1,170.00	
Other Planning Applications and Processes		
Removal of Part Lot Control	\$1,263.00	\$1,263.00
Removal of Holding Symbol	\$632.00	\$3,932.00
Deeming By-Law	\$632.00	
Extension of a Temporary Use By-Law	\$3,162.00	\$9,319.00
Communication Towers and Renewable Energy Application	\$1,263.00	\$4,607.00
Change of Address	\$135.00	\$306.00
Repeal of Interim Control By-Law	\$1,263.00	\$1,263.00
Lifting of Inhibiting Order	\$632.00	
Lifting of One Foot Reserve	\$632.00	
Property Standards Appeal	\$632.00	
Aggregate Application Fees	Full Cost Recovery	
Zoning Information Letter (10 Business Day Service)	\$114.00	\$139.00
Real Estate Compliance Letter (10 Business Day Service)	\$153.00	\$235.00
Real Estate Compliance Letter (Expedited 4 Business day)	\$246.00	\$378.00
Town Consultant Review Fee *Consultant review may include full application costs for an RPP Consultant to undertake the application review in full/part and or specific consultant review expertise of studies and requirements	Full Cost Recovery	



Planning & Development Services

2025

Region of Niagara Fees to Take Effect When Region Becomes Upper Tier Municipality Without Planning Authority (Note: Regional fees subject to fee increase change by the Region of Niagara)

Official Plan Amendments

Regional Official Plan Amendment Review	\$11,205.00
Regional OPA - Urban Boundary Expansion	\$11,205.00
Regional OPA – Establish or Expand Pit or Quarry	\$114,100.00
Major OPA Review (3 or more types of policy review)	\$4,775.00
Minor OPA Review (2 or less types of policy review)	\$2,450.00

Subdivision, Vacant Land or Common Element Condominium Fees

Draft Plan Review Base Fee	\$1,790.00
Draft Plan Per Ha. Fee (Note: fee is Base fee + Per Ha. fee)	\$790.00
Revision of Submission by Applicant Prior to Draft Approval	\$1,925.00
Modification of Draft Approval	\$1,925.00
Extension of Draft Approval	\$1,395.00
Extension of Draft Approval Approved Prior to 2006	\$2,775.00
Clearance of Draft Plan Conditions (per Phase)	\$1,925.00

Standard Condominium Fees

Standard Condominium Draft Plan Review	\$1,775.00
Revisions to Submission by Applicant Prior to Draft Approval	\$1,245.00



Planning & Development Services

2025

Region of Niagara Fees to Take Effect When Region Becomes Upper Tier Municipality Without Planning Authority (Note: Regional fees subject to fee increase change by the Region of Niagara)

Standard Condominium Fees (Continued)

Modification to Standard Condominium Draft Approval	\$1,245.00
Extension of Standard Draft Condominium Approval	\$890.00
Extension of Standard Draft Condominium Approval Prior to 2006	\$890.00
Clearance of Standard Condominium Conditions	\$1,600.00

Zoning By-law Application Fees

Major Zoning By-law Amendment Review	\$2,500.00
Minor Zoning By-law Amendment Review	\$1,395.00
Agricultural Purposes Only (APO) Review	\$1,090.00
Revision to Submission by Applicant Prior to Approval (Major)	\$1,075.00
Removal of Holding Symbol	\$895.00

Consent to Sever Application Fees

Consent Review – Urban	\$510.00
Consent Review – Rural/Outside Urban	\$835.00
Final Certification Fee (active files under Regional Authority)	\$740.00

Site Plan Fees

Major Site Plan Review	\$1,345.00
Revision to Submission by Applicant Prior to Approval	\$780.00
Clearance of Conditions	\$995.00

Minor Variance Application

Minor Variance Review	\$760.00
-----------------------	----------



Planning & Development Services

2025

Region of Niagara Fees to Take Effect When Region Becomes Upper Tier Municipality Without Planning Authority (Note: Regional fees subject to fee increase change by the Region of Niagara)

Niagara Escarpment Plan Applications

Development Permit Review	\$2,225.00
Minor Development Permit Review (no provincial/regional interests-pools/sheds)	\$830.00

Environmental Site Assessments, Request to Use Non-Potable Water, Site Conditions

Response to Request	\$410.00
Response to Request – Update Letter	\$150.00

Secondary Plan Review Fees

Secondary Plans Privately Initiated	\$6,935.00
-------------------------------------	------------

Pre-Consultation Fees

Pre-Consultation Review	\$500.00
-------------------------	----------

Special Studies Fees

Environmental Review	
Major EIS Review (2 features or more)	\$3,060.00
Minor EIS Review (1 feature)	\$1,530.00
Major Environmental Impact Study (EIS) Review (2 or more features) – No approved terms of reference	\$4,045.00
Minor EIS Review (1 feature) – No Approved Terms of Reference	\$2,355.00
EIS Terms of Reference Review	\$555.00
EIS Second Submission and Greater (Addendum) Review	Half the Original Fee
EIS Draft Review	\$555.00



Planning & Development Services

	2025
Special Studies Fees (Continued)	
Review of Restoration Plan	\$760.00
Review of Tree Preservation Plan	\$380.00
Review of Monitoring Plan	\$975.00
Urban Design	
Major Urban Design Review	\$1,000.00
Minor Urban Design Review	\$300.00
Building Permit Fees	
Minimum Permit Fee unless otherwise stated	\$293.00
New Construction – per square foot	
Assembly Occupancies – Group A	
School, church, restaurant, theatre, educational or recreational facility and similar occupancies	\$2.02
Preparation of record for disclosure – each 15 minutes	\$8.47
Institutional Occupancies – Group B	
Hospital, nursing home, reformatory, prison and similar occupancies	\$2.02
Residential Occupancies – Group C	
Single Family Dwelling, Semi-Detached Dwelling & Duplex Dwelling	\$1.66
Multiple Unit Dwelling i.e. apartment dwelling, townhouse dwelling, hotels, motels, other residential buildings or parts thereof	\$1.70
Residential Additions	\$1.47
Business/Personal Services Occupancies – Group D	
Office, bank, medical office/clinic and similar occupancies	\$2.02
Mercantile Occupancies – Group E	
Store, shopping mall/plaza, shop, market, retail outlet and similar	\$2.02



Planning & Development Services

	2025
New Construction – per square foot (Continued)	
Mercantile Occupancies – Group E	
Store, shopping mall/plaza, shop, market, retail outlet and similar occupancies	
Industrial Occupancies – Group F	
Industrial mall, plaza, garage, plant, factory, warehouse, manufacturing building and similar occupancies	\$1.88
Special Occupancies / Categories	
New Farm Buildings	\$.58
Tents	\$293.00
Special Occupancies/Categories per square foot	
Park Model Trailer, Mobile Home	\$293.00
Accessory Buildings/Structures	
Garage/Carport, Deck/Porch/Patio, Sunroom/Solarium, shed or other accessory building	\$293.00 \$.98> 300/ft ²
Private Swimming Pool	\$293.00
Public Swimming Pool or Spa	\$878.00
Designated Buildings/Structures	
Communication Tower, Solar Panels, Retaining Wall, Pedestrian Bridge, Wind Turbine, Crane Runway and similar buildings/structures	\$585.00
Alterations & Repairs – per square foot	
Interior Alterations/Repairs/Tenant Improvements	\$0.46
Assembly occupancies – Group A	
Institutional Occupancies – Group B	\$0.46
Residential Occupancies - Group C	\$0.36
Business/Personal Service - Group D	\$0.46



Planning & Development Services

	2025
Interior Alterations/Repairs/Tenant Improvements (Continued)	
Mercantile Occupancies - Group E	\$0.46
Industrial Occupancies - Group F	\$0.46
Alterations/Additions to existing Farm Buildings	\$0.32
Alter/Replace Roof Structure	\$.46
Fireplace, Woodstove, Insert, Chimney and similar construction	\$293.00
Demolition	
Part 9 Buildings/Structures	\$293.00
Other	\$878.00
Miscellaneous	
Partial Occupancy (does not apply to single family dwellings)	\$293.00
Change of use of a building or part thereof	\$293.00
Transfer of a Permit to a New Owner	\$293.00
Request for Deferral of Permit Revocation	\$293.00
Move a Building/Structure	\$293.00
Conditional Permit	\$702.00
Conditional Permit Agreement	\$293.00
Permit Renewal / Per Year	\$128.00
Re-inspection Fee	\$88.00
Clearance Letter	\$88.00
Building Code Order Compliance Letter	\$177.00
Hourly Rate	\$76.00
Occupant Load Inspection	\$293.00
Photocopying & printing per page	\$0.30



Planning & Development Services

	2025
Alternative Solution Review	\$585.00
Partial Permit/Staged Construction	
Building Foundation	15%
Building Shell	75%
Building Completion	10%
Plumbing	
For plumbing work not included in any of the above classes of permit	
First 6 fixtures	\$293.00
Each additional	\$11.71
Refund of Permit Fees	
Where only administrative functions have been completed (application received and cost analysis complete)	90%
Where only administrative and zoning functions have been completed	80%
Where administrative, zoning and plans examination functions have been performed	60%
Where the permit has been issued and no inspections performed	50%
Deduction for each inspection performed	5%
No fees shall be refunded after twelve (12) months from the date of permit issuance or when refund is less than \$100	
Construction Prior to Permit Issuance	
Where construction has commenced prior to the issuance of a permit for any class of permit described herein, the permit fee shall be doubled	
Municipal Property Damage	Full Cost Recovery



Recreation & Cultural Services

2025

Arena Rentals

Ice Time – per hour (50min)

Prime Time - Weekdays 4pm – midnight & weekends	\$226.00
Prime Time - Youth	\$162.50
Non-Prime Time – Weekdays prior to 4pm	Y \$100.00/A 134.00
Prime Time Last Minute Ice (less than 24hrs notice)	Y \$85.00/A \$134.00
Trainers Rate – 5 max	\$70.00
School Ice Rate	85.00

Spring/Summer Ice (April 1 – September 1)

Non-Prime Time	\$134.00
Prime Time - Youth	\$162.50
Prime Time – Adult	\$226.00

Corporate Sponsor Free Skate Rates

Prime Time Saturday Skate Sponsorship per occurrence	\$314.00
Prime Time Sunday Skate Sponsorship per occurrence	\$366.00
Non-Prime Public Skate Sponsorship per occurrence	\$180.00

Public Skating

Adults	\$3.98
Students	\$3.54
Child	\$3.54
Family (up to 5 members)	\$11.95
Preschool Skate	\$3.54
Non-Profit Organized Group Rate	\$30.09

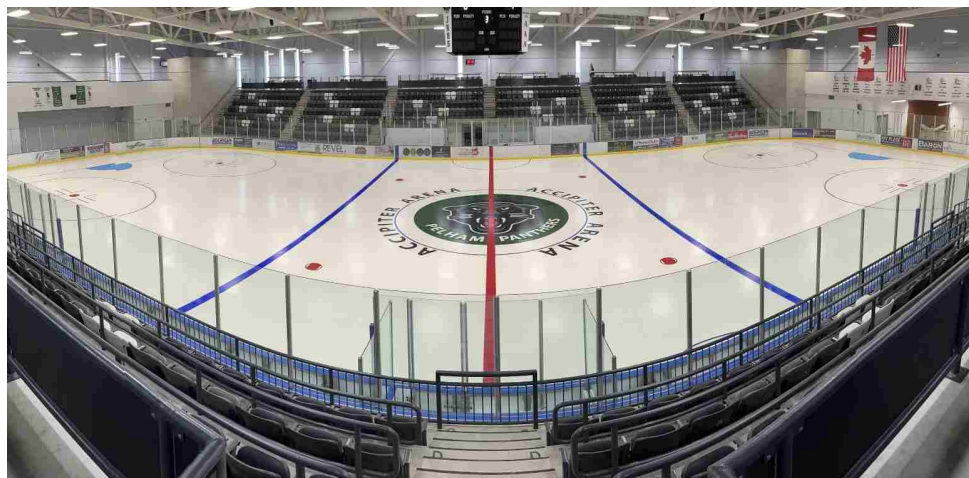

Recreation & Cultural Services

	2025
Arena Rentals (continued)	
Special Skating	
Shinny Hockey Drop-In	\$5.31
Shinny Membership (20)	\$88.50
Women's Hockey – Learn To Play Drop-In	\$5.31
Women's Hockey – Learn To Play Program + Shinny Combo	\$8.85
Adult Learn To Skate Program (per class)	8.85
Ticket Ice	\$5.31
Summer Floor Rates	
Hourly – Adult	\$100.00
Hourly – Youth	\$52.00
Daily Event	\$610.00
Daily - Youth	\$400.00
Event Electrical System Includes ESA inspection	\$1,200.00
Table/Chairs Rentals per item/per event	\$10.00 / \$5.00
MCC Arena Advertising	
Accipiter Arena	
Boards (Per Year)	\$1,000.00
Duliban Insurance Arena	
On Ice (Per Ice Season/Year)	\$1200.00
Boards (Per Year)	\$1,000.00
Wall Boards (Per Year)	\$600.00



Recreation & Cultural Services

		2025
Rentals (continued)		
Clip Frames		\$10.00/wk or \$25.00/mth
Ice Resurfacer (Per Side/Year)		\$2,000.00
Old Pelham Town Hall		
Monday – Thursday (Daily Rental)		\$200.00
Monday – Thursday (Hourly Rental)		\$45.00
Friday – Sunday & Holidays (Daily Rental)		\$320.00
Friday – Sunday & Holidays (Hourly Rental)		\$65.00
Youth/Multiple Use Rate (5+) (Daily Rental Mon to Thurs)		\$175.00
West Lounge		\$75.00
Stage Rental per set up		\$250.00
Refundable Security Deposit (taxes not applicable)		\$100.00
ENTANDEM – Socan/Resound Fees – without dancing per event		Full Cost Recovery
ENTANDEM – Socan/Resound Fees – with dancing per event		Full Cost Recovery
Meridian Community Centre Gymnasiums		
½ gymnasium rental (hourly) Licensed Users-Youth Rate/Service Club		\$16.00
Full size gymnasium rental (hourly)		\$52.00
Full size gymnasium rental daily (Service Club)		\$308.00
½ gymnasium rental (hourly)		\$28.00
Custodial Charge (hourly)		\$40.00



Recreation & Cultural Services

	2025
Rentals (continued)	
Team Chairs (per event)	\$129.00
Table/Chair Rentals (per item/per event)	\$10.00 / \$5.00
Set up & Use of Nets & Standards (Volleyball & Pickleball)	\$10.00
Equipment Rental (Volleyball, Pickleball Racket with ball)	\$3.00/event
Gym Floor Covering (Per Gym)	\$271.25/event
Meridian Community Centre – Kinsmen Community Room	
FULL ROOM	
Daily – Monday to Thursday	145.00
Hourly – Monday to Thursday	37.00
Daily – Friday to Sunday & Holidays	258.00
Hourly – Friday to Sunday & Holidays	53.50
HALF ROOM	
Daily – Monday to Thursday	71.50
Hourly – Monday to Thursday	20.00
Daily – Friday to Sunday & Holidays	129.00
Hourly – Friday to Sunday & Holidays	28.00
Meridian Community Centre – Dr. Gary & Mall Accursi	
Multipurpose Community Room	
FULL ROOM	
Daily – Monday to Thursday	\$216.00
Hourly – Monday to Thursday	\$55.00
Daily – Friday to Sunday & Holidays	\$388.00
Hourly – Friday to Sunday & Holidays	\$79.00



Recreation & Cultural Services

	2025
Rentals (continued)	
HALF ROOM	
Daily – Monday to Thursday	\$145.00
Hourly – Monday to Thursday	\$37.00
Daily – Friday to Sundays & Holidays	\$258.00
Hourly – Friday to Sundays & Holidays	\$53.50
Special Functions Area	
Hourly	\$24.00
Daily	\$90.00
Daily (with rental of Dr. Gary & Mall Accursi Multipurpose Comm Room)	\$56.00
Community Room – Kitchen	
Daily (with rental of Dr. Gary & Mall Accursi Multipurpose Comm Room)	\$56.00
Hourly (with rental of Dr. Gary & Mall Accursi Multipurpose Comm Room)	\$20.00
Atrium	
Table/Chairs Rentals (per item/per event)	\$10.00/ \$5.00
MCC Servery – Ciolfi's Corner	
Hourly	\$36.00
MCC – Small Meeting Room (RCW Meeting Room & Main Floor)	
Monday to Thursday (Daily)	\$54.00
Friday to Sunday & Holidays (Daily)	\$85.50
Monday to Thursday (Hourly)	\$13.50
Friday to Sunday & Holidays (Hourly)	\$18.50



Recreation & Cultural Services

2025

Rentals (continued)

Miscellaneous

Refundable Security Deposit (taxes not applicable)	\$100.00
Last Minute Cancellation Fee (less than 24hrs)	Full Rate
ENTANDEM – Socan/Resound Fees - without dancing per event	Full Cost Recovery
ENTANDEM – Socan/Resound Fees – with dancing per event	Full Cost Recovery
Stage Rental per set up	\$130.00
Pelham Minor Hockey Association Courtyard (Hourly/Daily)	\$31.00/\$129.00
Portable Bar per rental	\$129.00
Serving Fee per event	-
Linen Rental Fees per Item	\$12.50
Propane Heaters Rental Fee per Heater	\$31.00

Summer Field Rate Schedule

Ball Diamonds

Level "A" groomed and lined games	\$26.00
Level "A" youth games	\$18.50
Level "C" no service Adult	\$15.50
Level "C" youth practice	\$11.50
Diamond Lights (per hour)	\$32.00

Tournaments

Level "A" 1 x groomed and lined	\$204.00
Level "A" youth 1 x groomed & lined per field per day	\$145.00



Recreation & Cultural Services

2025	
Summer Field Rate Schedule (Continued)	
Staff per hour per staff – additional groom & lining	\$40.00
Note: Fees do not include use of lights – apply per hour light fee if required	
Soccer Fields per hour	
Adult	\$25.00
Minor	\$19.50
Soccer Lights (per hour)	\$32.00
Tournament	
Adult	\$195.00
Minor	\$151.00
Soccer Field Lining – Non-Municipal Fields per facility per lining	\$206.00
Park Pavilions: Centennial Park & Harold Black Park & MSSP Park Pavilion	
Park Pavilion	\$60.00
Passive Areas: Centennial Park & Harold Black Park & MSSP	
Permit Fee + Insurance	\$52.00
Peace Park including Bandshell	
Pavilion Rate + Passive Area Rate (under 100 people)	\$115.00
Pavilion Rate + Passive Area Rate (over 100 people)	\$232.00
Per Hour Rate	\$27.00
ENTANDEM – Socan/Resound Fees	Full Cost Recovery
Town Staff fee (per hour)	\$40.00
Hydro Fee for One Time Events	\$46.00



Recreation & Cultural Services

	2025
Centennial Park Tennis and Pickle Ball Courts	
Family Membership	\$150.00
Single Adult Membership	\$100.00
Single Student	\$50.00
Children (12 years and under)	Free
Outdoor Court Instructor Rental – per court/per day (up to 3 hrs)	\$20.00
Key Fob Deposit Fee (deposit returned upon return of Fob)	\$50.00
Lesson Fees will be determined based on competitive rates	
Storage Space Per Year	
Youth Organization Storage	\$500.00
Centennial/ H.B. Park	\$50.00
Supply Rentals (Daily Fee with Facility Rental)	
Picnic Table/Folding Table	\$25.00
Folding Cruiser Table	\$12.00
10 x 10 Tents with Weights	\$80.00
Kids Folding Table	\$12.00
Refundable Equipment Deposit (taxes not applicable)	\$100.00
Aquatic Rates	
Swimming Lessons	
Parent & Tot 1, 2, 3	\$72.00
Preschool 1-5	\$83.00
Swimmer 1, 2	\$83.00
Swimmer 3, 4, 5, 6	\$89.00
*Swim Discounts 25% off 3rd child (Pre 1 – Swimmer 7/8/9 in same session)	



Recreation & Cultural Services

	2025
Aquatic Rates (Continued)	
Patrol (Rookie, Ranger, Star)	\$97.00
Private Lessons (10)	\$190.00
Semi-Private Lessons (10)	\$160.00
Bronze Star	\$100.00
Bronze Medallion/Emergency First Aid CPR (Additional Fee for Materials)	\$177.00
Canadian Lifesaving Society Manual	Cost
Bronze Cross	\$150.00
Swim Team	\$125.00
Facility Charges	
Pool Rental per hour (includes 2 lifeguards) + Insurance	\$116.25
Lifeguard Fee Per hour	\$30.00
Public Swim Rates	
Adult	\$3.98
Child	\$3.54
Family	\$11.95
Swim Pass – Single	\$55.75
Swim Pass - Family	\$101.77
Aqua Zumba	\$6.20
Camp Rates	
March Break Camp	
Single Week	\$200.00

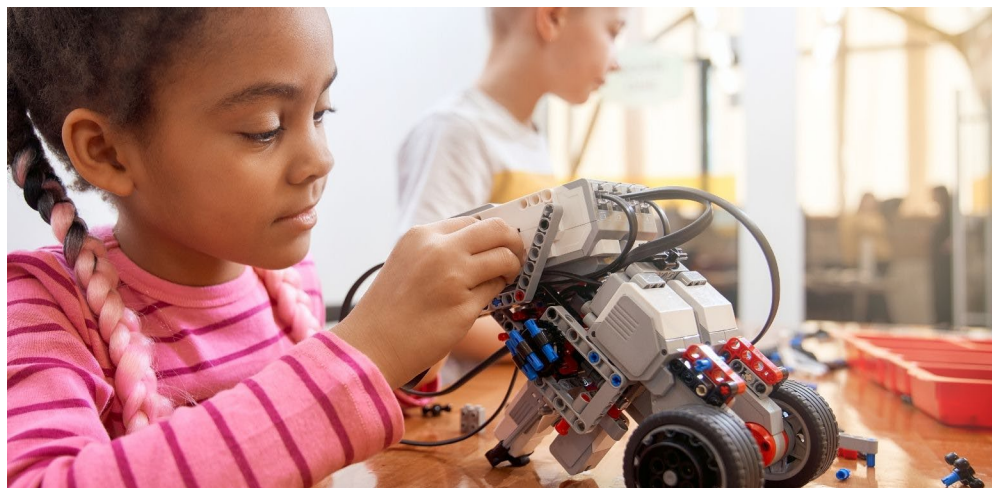

Recreation & Cultural Services

	2025
Camp Rates (Continued)	
Family Weekly Registration Discount Each Child after 2nd Child	(\$30.00)
Extended Care per week	\$38.00
Lunch per week (subject to change)	\$48.50
Lunch per day (subject to change)	\$10.00
Leaders in Training Program	\$115.50
Refund Administration Fee	\$20.00
Winter Break Camp (3 Day camp)	\$120.00
Summer Camp	
Single Week Registration	\$200.00
Multiple Week Registration discount each week after 2 weeks	(\$10.00)
Family Weekly Registration Discount Each Child after 2nd Child	15%
Extended Care per week	\$38.00
Extended Care Multiple weeks (3 weeks or more)	\$33.00
4 Day Camp Week (Due to Holiday)	\$160.00
Refund Admin Fee – before June 1	\$20.00
Refund Admin Fee – After June 1 – 2 weeks prior to camp week	\$50.00
Specialty Programs/Camps	
Single Week Registration	\$220.00 - \$400.00
Extended Care per week	\$38.00
Ballroom Dance Lessons (10 Classes) (50% off 2nd and 3rd class)	\$88.50
Ballroom Social Tickets	\$15.00



Recreation & Cultural Services

		2025
Specialty Programs/Camps (Continued)		
Activity Drop-in Fee Adult		\$5.31
Activity Membership (20) Adult		\$88.50
Activity Drop in Fee Youth		\$3.10
P.D Camp Registration includes lunch		\$65.00
Workshops per person	\$30.00 - \$125.00	
Brock Fit (12 weeks)	\$168.14	
Pickleball Clinics (Per Person)	\$15.00 - \$20.00	
Spin classes 10-week session/Drop In	\$100.00/\$10.00	
Spin Room Membership (per month)		\$50.00
Municipal Property Damage		Full Cost Recovery
Overnight Parking at the Meridian Community Centre		
Overnight Parking at the MCC per night (HONK)		\$10.00
Overnight Parking at the MCC per month (HONK)		\$100.00



Public Works

	2025		
Culvert Fees	3m	6m	9m
250 mm Culvert + Coupler	Full Cost Recovery	Full Cost Recovery	Full Cost Recovery
300 mm Culvert + Coupler	Full Cost Recovery	Full Cost Recovery	Full Cost Recovery
375 mm Culvert + Coupler	Full Cost Recovery	Full Cost Recovery	Full Cost Recovery
450 mm Culvert + Coupler	Full Cost Recovery	Full Cost Recovery	Full Cost Recovery
525 mm Culvert + Coupler	Full Cost Recovery	Full Cost Recovery	Full Cost Recovery
600 mm Culvert + Coupler	Full Cost Recovery	Full Cost Recovery	Full Cost Recovery
*** larger or off sizes Full Cost Recovery			
Cemeteries			
Resident Rates			
Land Acquisition			
Adult Grave			\$863.00
Perpetual Care per Lot			\$567.00
Columbarium Niche			\$2,561.00
Perpetual Care per Niche (15%)			\$453.00
Non-Resident Rates			
Land Acquisition			
Adult Grave			\$1,632.00
Perpetual Care per Lot			\$1,088.00
Columbarium Niche			\$3,192.00
Perpetual Care per Niche (15%)			\$564.00
Interment Fees (not including Administrative Fee)			
Standard Burial			



Public Works

2025

Cemeteries (Continued)

Adult

Opening and Closing Weekdays	\$865.00
Opening and Closing Saturday Morning	\$1,240.00
Opening and Closing Saturday Afternoon	\$1,305.00

Infant

Weekdays	\$406.00
Saturday	\$826.00

Non-Resident Fees (not including Administrative Fee)

Standard Burial

Adult

Opening and Closing Weekdays	\$1,038.00
Opening and Closing Saturday Morning	\$1,488.00
Opening and Closing Saturday Afternoon	\$1,566.00

Infant

Weekdays	\$488.00
Saturday	\$992.00

Cremated Remains

Weekdays	\$320.00
Saturday	\$629.00
Columbarium Weekday	\$384.00
Columbarium Saturday	\$643.00

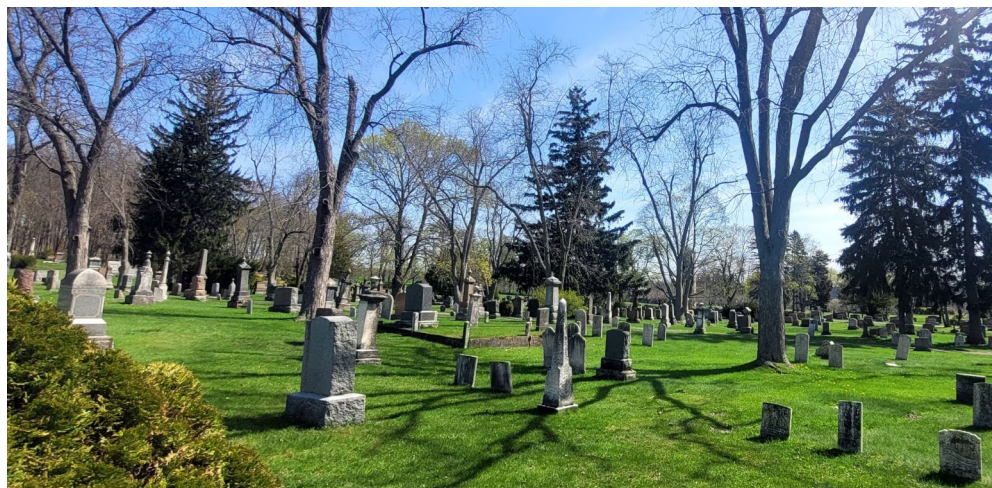

Public Works

	2025
Cemeteries (Continued)	
Mausoleum	
Weekdays	\$352.00
Saturday	\$529.00
Disinterment Charges	
Adult/Child Disinterment Only	\$1,081.00
Infant/Stillborn Disinterment Only	\$359.00
Cremains Disinterment Only	\$781.00
Columbarium Removal Only	\$317.00
Foundation Charges	
Foundation Charge per Cubic Foot	\$48.00
Markers	\$104.00
Cornerstones	\$110.00
Administration Fees	
Interment Administrative Fee	\$31.00
Interment Rights Transfer	\$61.00
Interment Rights Exchange	\$61.00
Interment Rights Replacement/Duplicate	\$37.00
Cemetery Records Search – per Hour	\$32.00
Marker Perpetual Care and Maintenance	
Upright Marker Four Feet or Less in Height and Length	\$200.00
Upright Market More Than Four Feet in Height or Length	\$400.00



Public Works

	2025
Flat Marker Over 173 Square Inches	\$100.00
Other Fees	
Columbarium Plate (not including costs of engraving to Town specifications)	\$82.00
Overtime Rate per Hour	\$364.00
Archaeological Dig – per Hour (not including ministry charges)	\$99.00
Dedication Items with Plaque (includes engraving)	
Wheelchair Accessible Picnic Table	\$4,000.00
6-Foot “Pelham Bench”	\$3,000.00
Pride Bench	\$3,000.00
Bike Repair Station	\$4,500.00
Concrete Ping Pong Table	\$10,500.00
Chess/Checkers Games Table	\$4,000.00
Tree Dedication	\$750.00
Permit Fees	
Special Event Permits Inspection Fee	\$170.00
Municipal Permit and Inspection Fee	\$170.00
Road Closure/Open Fees	
Closure/Open (4 hours Minimum) Cost includes for one block closure and includes two road closed signs. Requests above this would be full cost recovery	\$260.00



Public Works

2025

Road Closure / Open Fees (Continued)

Overtime – Closure/Open

\$321.00

Cost includes for one block closure and includes two road closed signs.
Requests above this would be full cost recovery

Double Time Sunday and Holidays – Closure / Open

\$395.00

Cost includes for one block closure and includes two road closed signs. Requests above this would be full cost recovery

Barricade/Cone/Barrel Deposit – Refundable

Under 10 Units

\$112.00

10 – 20 Units

\$225.00

Over 20 Units

\$562.00

Unsolicited Request to Purchase Lands Due Diligence Fee

\$1,339.00

Municipal Property Damage

Full Cost Recovery

Development Inspection per diem

Full Cost Recovery

Closed Road Allowance Disposal Charges

Full Cost Recovery

Special Customized Signage

Full Cost Recovery

Level 2 EV Charger (per hour)

\$2.00/hour

Level 3 EV Chargers (per hour)

\$22.00/hour



Public Works

Engineering Fees	2025	Fees effective Sept. 1, 2025
Pre-servicing Agreement		\$2,136.00
Temporary Works Permit		\$661.00
Consolidated Linear Infrastructure Environmental Compliance Approval – Stormwater Management Ponds		\$3,954.00
Consolidated Linear Infrastructure Environmental Compliance Approval – Stormwater Amendments		\$1,820.00
Consolidated Linear Infrastructure Environmental Compliance Approval – Wastewater Amendments		\$1,820.00
Minor - Site Alteration Permit		\$660.00
Site Alteration Permit (Residential 10 Units or Less)		\$1,156.00
Grading Review		\$414.00
Consent - Clearance of Conditions		\$942.00

**Inquiries related to this user fee and charges guide
and requests for alternate formats can be directed to:**

The Corporation of the Town of Pelham
Attention: Corporate Services Department
Town of Pelham, Municipal Building
P.O Box 400, 20 Pelham Town Square
Fonthill, Ontario
L0S 1E0