

SCHEDULE 'A6'

To By-law No. 1136 (1987)

Zone Categories

RESIDENTIAL ZONES

- SR SPECIAL RURAL
- RV1 RESIDENTIAL VILLAGE 1
- RV2 RESIDENTIAL VILLAGE 2
- RMV1 RESIDENTIAL MULTIPLE VILLAGE 1
- RMV2 RESIDENTIAL MULTIPLE VILLAGE 2
- R1 RESIDENTIAL 1
- R2 RESIDENTIAL 2
- R3 RESIDENTIAL 3
- RM1 RESIDENTIAL MULTIPLE 1
- RM2 RESIDENTIAL MULTIPLE 2
- RD RESIDENTIAL DEVELOPMENT

COMMERCIAL ZONES

- NC NEIGHBOURHOOD COMMERCIAL
- GC GENERAL COMMERCIAL
- HC HIGHWAY COMMERCIAL
- CR COMMERCIAL RURAL

INDUSTRIAL ZONES

- M1 LIGHT INDUSTRIAL
- M2 GENERAL INDUSTRIAL
- M3 INDUSTRIAL EXTRACTIVE

OTHER ZONES

- A AGRICULTURAL
- I INSTITUTIONAL
- P PUBLIC
- OS OPEN SPACE
- H HAZARD

OFFICE CONSOLIDATION

This is an Office Consolidation of Zoning By-law No. 1136 (1987) for the Corporation of the Town of Pelham, as passed by Council on June 23rd, 1987.

For accurate reference, recourse should be made to the original Zoning By-law No. 1136 (1987) and amending By-laws.

CONSOLIDATED TO JUNE 2017

This is Schedule 'A6' to By-law No. 1136 passed this 23rd day of June 1987.

ORIGINALLY SIGNED BY MURRAY HACKETT

ORIGINALLY SIGNED BY E.G. BERGENSTEIN

DIGITAL ZONING MAP	
DATE: JUNE 2017	SCALE: 1:12,500
DRAWN BY: C.T.	CAD FILE: MAP A6
ASSESSMENT MAPPING - FEBRUARY 2017	

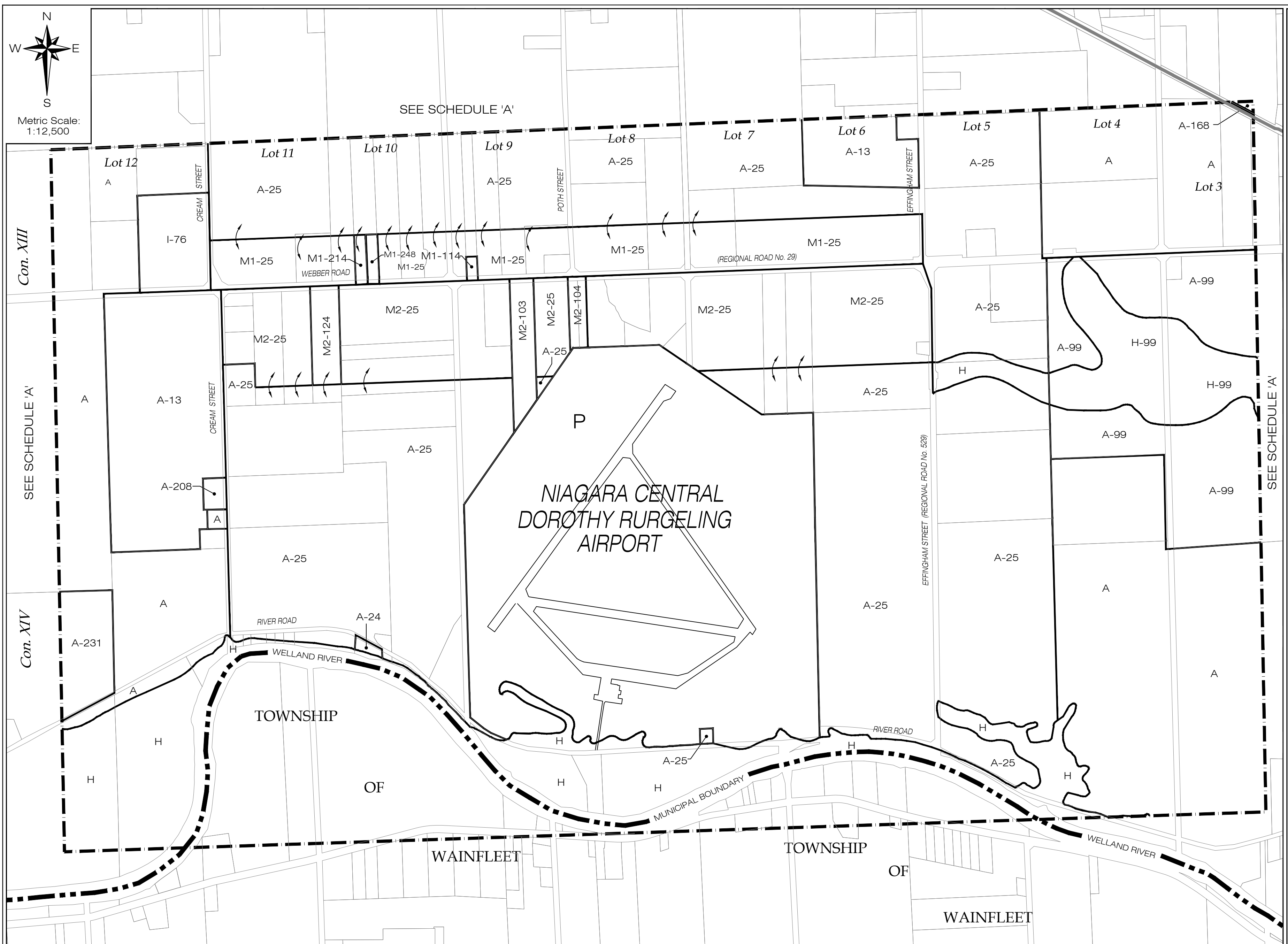

Metric Scale:
1:12,500

Con. XIII

SEE SCHEDULE 'A'

Con. XIV

ZONE AMENDMENTS & BY-LAWS TO THE ZONING BY-LAW

- | | | | |
|---|---|---|--|
| <ul style="list-style-type: none"> • A to A-13 • OS to A-99 & H to H-99 • M2-25 to M2-104 & M2-25 • M2-25 to M2-103 • Lands deleted from Zoning By-law: • M1-25 to M1-114 • M2 to M2-124 • M2-25 to M2-124 • A to A-168 • M2-25 to A-25 • A to A-208 & A-13 • 2812 (2006) | <ul style="list-style-type: none"> 1217 (1988) 1364 (1990) 1391 (1991) 1392 (1991) 1417 (1991) 1545 (1993) 1671 (1994) 1987 (1994) 2393 (2002) 2554 (2004) 2765 (2006) | <ul style="list-style-type: none"> • A-25 to A-215 & M1-25 to M1-214 [TEMPORARY USE-EXPIRED] • A to A-231 • M1-25 TO M1-214 • M2-124; A-25 • M2-124 • M1-25 to M1-248 | <ul style="list-style-type: none"> 2863 (2007) 3289 (2012) 3331 (2013) 3390 (2013) 3416 (2013) 3524 (2014) |
|---|---|---|--|