

SCHEDULE 'A5'

To By-law No. 1136 (1987)

Zone Categories

RESIDENTIAL ZONES

- SR SPECIAL RURAL
- RV1 RESIDENTIAL VILLAGE 1
- RV2 RESIDENTIAL VILLAGE 2
- RMV1 RESIDENTIAL MULTIPLE VILLAGE 1
- RMV2 RESIDENTIAL MULTIPLE VILLAGE 2
- R1 RESIDENTIAL 1
- R2 RESIDENTIAL 2
- R3 RESIDENTIAL 3
- RM1 RESIDENTIAL MULTIPLE 1
- RM2 RESIDENTIAL MULTIPLE 2
- RD RESIDENTIAL DEVELOPMENT

COMMERCIAL ZONES

- NC NEIGHBOURHOOD COMMERCIAL
- GC GENERAL COMMERCIAL
- HC HIGHWAY COMMERCIAL
- CR COMMERCIAL RURAL

INDUSTRIAL ZONES

- M1 LIGHT INDUSTRIAL
- M2 GENERAL INDUSTRIAL
- M3 INDUSTRIAL EXTRACTIVE

OTHER ZONES

- A AGRICULTURAL
- I INSTITUTIONAL
- P PUBLIC
- OS OPEN SPACE
- H HAZARD

N.E.C. PLAN BOUNDARY
NOTE: Section 6.36 provides that this zoning by-law have no effect within the N.E.C. Development Control Area, as defined by provincial regulation.

- MUNICIPAL BOUNDARY

- URBAN AREA BOUNDARY

- CENTRAL BUSINESS AREA (CBA)

OFFICE CONSOLIDATION

This is an Office Consolidation of Zoning By-law No. 1136 (1987) for the Corporation of the Town of Pelham, as passed by Council on June 23rd, 1987.

For accurate reference, recourse should be made to the original Zoning By-law No. 1136 (1987) and amending By-laws.

CONSOLIDATED to April 2020

This is Schedule 'A5' to By-law No. 1136 passed this 23rd day of June 1987.

ORIGINALLY SIGNED BY MURRAY HACKETT

ORIGINALLY SIGNED BY E.G. BERGENSTEIN

DIGITAL ZONING MAP

DATE: April 2020	SCALE: 1:12,500
DRAWN BY: C.T.	CAD FILE: MAP A5
ASSESSMENT MAPPING - March 2020	

- HC-162 3376 (2013)
- R1 to R1-241 3437 (2013)
- R2(H) to R2; RM1-223(H) to RM1-223 3459 (2014)
- A to R2-243 & OS-244 3494 (2014)
- R2 to R2-252 3542 (2014)
- A to EF-MU1, EF-MU2, EF-MU3, EF-OS, EF-EP & EF-SWM 3543 (2014)
- I to R2 3586 (2015)
- R1(H), R1-209(H), R1-210(H) & OS to RM1-253 3678 (2015)
- NC-108 & A to RM1(H) 3680 (2015)
- NC-108 & A to NC-108 3681 (2015)
- R1 to R1(H) 3698 (2016)
- A to R2-254, RM1-255, RM2-256, OS-257, OS-258 & OS-259 3705 (2016)
- EF-OS to EF-MU1 3711 (2016)
- A to RM1-263, R2 & RD 3719 (2016)
- A to RM1-264 3720 (2016)
- A to R2-266, R2-266(H), RM1-267, RM1-268, RM1-268(H), RM1-269(H), OS-270, OS-271, OS-272, OS-272(H), OS-273(H) 3810 (2016)
- NC-85 to GC-275(H) & RM1-276(H) 3867 (2017)
- R1 to R1 3948 (2017)
- R1 to RM1-281(H) 3949 (2017)
- RM1-267 & RM1-274 to RM1-267 3967 (2018)
- EF-MU1 & EF-OS to EF-MU2; EF-OS to EF-MU3; EF-MU1 & EF-MU3 to EF-OS 3974 (2018)
- A to RM2-285 4002 (2018)
- A to R2-286, RM1-287 & RM1-288 4041 (2018)
- RM1(H) to RM1-289 4044 (2018)
- R2-266(H) to RM1-269(H); RM1-269(H) to R2-266(H) 4074 (2019)
- A to RM1-287 4083 (2019)
- A to RM1-295 4133 (2019)
- EF-MU2 (further amended by) 4136 (2019)
- A to R2-290, RM1-291, OS-292, OS-293 & EP-294 4138 (2019)
- R2-66(H), RM1-268(H), RM1-269(H), OS-272(H) & OS-273(H) to R2-266, RM1-268, RM1-269, OS-272 & OS-273 4197 (2020)
- R1-26 to R1-298 4220 (2020)

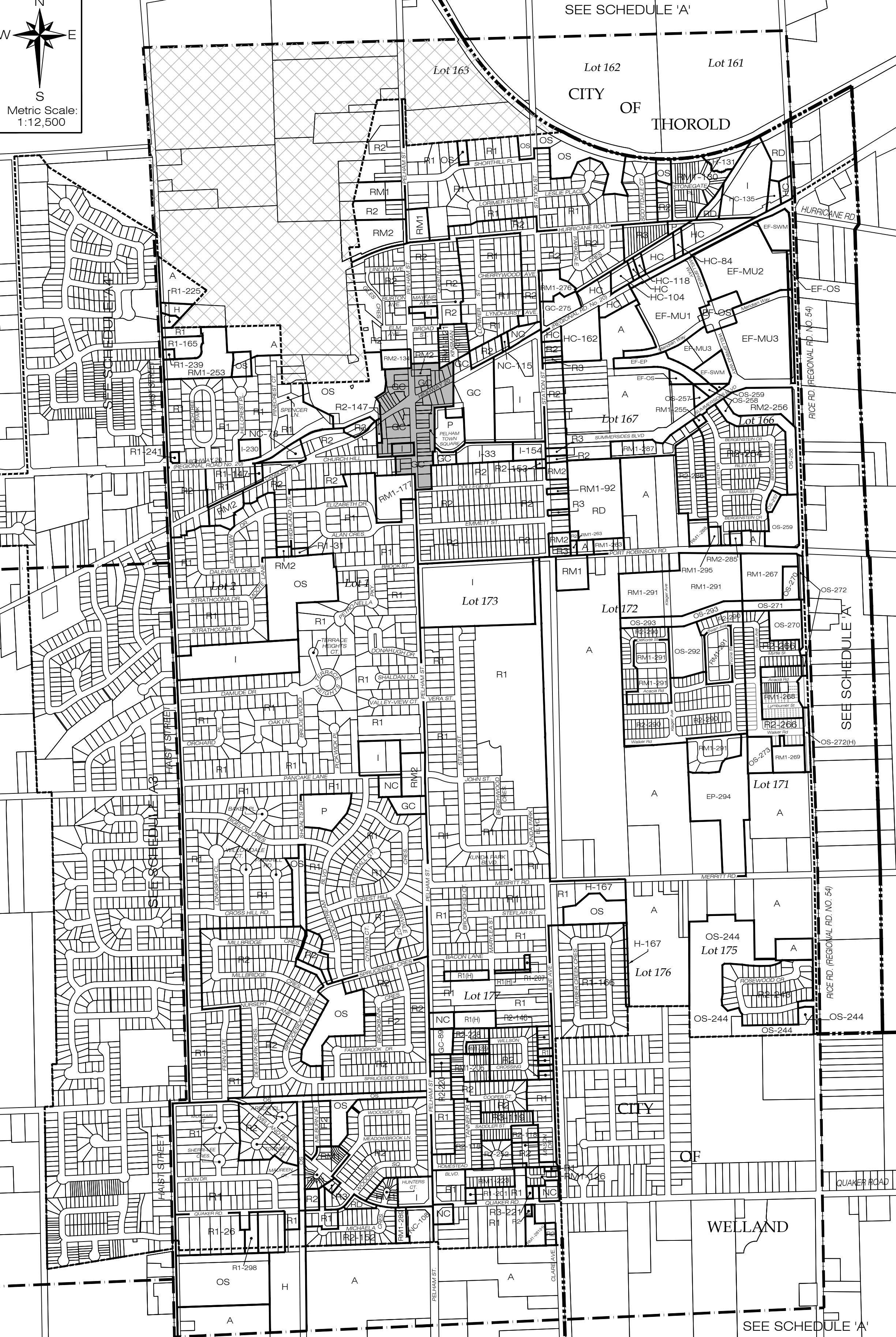
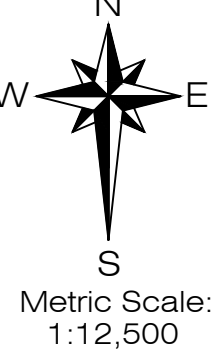

ZONE AMENDMENTS & BY-LAWS TO THE ZONING BY-LAW

• D & RM1 to RM2-79(H) 1151 (1987)	• RM1(H) 1411 (1991)	• P to P-138 & R1 1975 (1998)	• RM2-134 2699 (2005)
• R1 to R2 1152 (1987)	• RD to NC-108 (OMB Order - March 26, 1991) 1417 (1991)	• R1 to R2-146 2054 (1999)	• R2-118, R1, R1(H) to R2; R1(H) to RM1-206 2751 (2006)
• M1 to M1-81(H) 1209 (1988)	• Lands deleted from Zoning By-law 1417 (1991)	• R1 to R1-147 2083 (1999)	• R1 to R1(H) & R1-207 2764 (2006)
• M1 to M1-81(H) 1210 (1988)	• HC to HC-104, HC-105 & R2 1418 (1991)	• GC to R2 & R2-147 2113 (1999)	• R1 to A, R1-165, R1-209(H), R1-210(H) & R1(H); OS to R1-209(H), R1-210(H) & R1(H) 2776 (2006)
• RD to R3 1234 (1989)	• RD to NC-108 (OMB Order - February 28, 1992) 1495 (1992)	• RD to R1 & RD, A & RM1(H) to R2-152 2150 (2000)	• R1 to R1(H) 2816 (2006)
• RD to R1 1240 (1989)	• RM2(H) to R2-111(H) 1495 (1992)	• I-33 to I-154; R2 to R2-153 2187 (2000)	• R1 to R1(H) 2901 (2007)
• R1 to NC 1241 (1989)	• RM2 & OS to RM1-113 1544 (1993)	• HC-85 to HC-162 2305 (2001)	• R2(H) to R2 2966 (2008)
• RD & M1 to HC; M2 to HC-85; M1 & HC to HC-84 1261 (1989)	• RM1(H) to RM1 1572 (1993)	• R1 to RM1-164 & OS 2309 (2001)	• R1 to R1(H) 3070 (2009)
• RM2-87 1265 (1989)	• R2 to NC-115 1577 (1993)	• A to R1-164 & OS 2363 (2002)	• R1 to R3-220 3139 (2010)
• RM1(H) 1271 (1989)	• R1 to R2-118 & R3-119 1584 (1993)	• A & R1 to R1-165 2363 (2002)	• R1 to R3-221 & RM1-126 3070 (2009)
• RD to R1 1277 (1989)	• RM1-29 to RM1 1609 (1993)	• R1 to R2 & OS-178 2364 (2002)	• R1 & OS-178 to R2(H); R1(H) to RM1-223(H) 3178 (2011)
• NC-28, NC, R1 to GC-89 & NC-28, R1 to OS 1284 (1989)	• HC to HC-118 1626 (1994)	• I to RM1-177 2478 (2003)	• R1-165 to R1; A to H, R1 & R1-225 3208 (2011)
• RM2-79(H) to RM2-90(H) 1324 (1990)	• R2-34 to RM1-121 1640 (1994)	• R1 to R2 & OS-178 2521 (2003)	• R1 & R3-220 to R2-220 3237 (2011)
• R2-30 to R2 1331 (1990)	• RM2-87 to RM1-126 1724 (1995)	• P-138 to R1 2521 (2003)	• R1 to I-230 (OMB amended order PL121159) 2529 (2003)
• R2-32 to RM1-92 1334 (1990)	• R2-111 to R2, OS, RM1-30 & H-131 1784 (1996)	• R1 to R1(H) 2571 (2004)	• GC-89 & OS to R2-228; GC-89 & OS to RM1-229 3294 (2012)
• RM2-35 to RM2-93 & RM2 1352 (1990)	• RM1-113 to RM2-134 1824 (1996)	• R1 to R1(H) 2609 (2004)	• R1-165 to R1-239 3354 (2013)
	• HC to HC-135 1863 (1996)	• RM2 to R2 2611 (2004)	• HC-162 3376 (2013)
	• R1 to R2-118 1878 (1997)	• R1 to R2-118 2362 (2005)	• R1 to R1-241 3437 (2013)
		• R1 to R1(H) & R1-201 2691 (2005)	• R2(H) to R2; RM1-223(H) to RM1-223 3459 (2014)