

SCHEDULE 'A4'

To By-law No. 1136 (1987)

Zone Categories

RESIDENTIAL ZONES

- SR SPECIAL RURAL
- RV1 RESIDENTIAL VILLAGE 1
- RV2 RESIDENTIAL VILLAGE 2
- RMV1 RESIDENTIAL MULTIPLE VILLAGE 1
- RMV2 RESIDENTIAL MULTIPLE VILLAGE 2
- R1 RESIDENTIAL 1
- R2 RESIDENTIAL 2
- R3 RESIDENTIAL 3
- RM1 RESIDENTIAL MULTIPLE 1
- RM2 RESIDENTIAL MULTIPLE 2
- RD RESIDENTIAL DEVELOPMENT

COMMERCIAL ZONES

- NC NEIGHBOURHOOD COMMERCIAL
- GC GENERAL COMMERCIAL
- HC HIGHWAY COMMERCIAL
- CR COMMERCIAL RURAL

INDUSTRIAL ZONES

- M1 LIGHT INDUSTRIAL
- M2 GENERAL INDUSTRIAL
- M3 INDUSTRIAL EXTRACTIVE

OTHER ZONES

- A AGRICULTURAL
- I INSTITUTIONAL
- P PUBLIC
- OS OPEN SPACE
- H HAZARD

N.E.C. PLAN BOUNDARY
 NOTE: Section 6.36 provides that this zoning by-law have no effect within the N.E.C. Development Control Area, as defined by provincial regulation.

OFFICE CONSOLIDATION

This is an Office Consolidation of Zoning By-law No. 1136 (1987) for the Corporation of the Town of Pelham, as passed by Council on June 23rd, 1987.

For accurate reference, recourse should be made to the original Zoning By-law No. 1136 (1987) and amending By-laws.

Consolidated to April 2020

This is Schedule 'A4' to By-law No. 1136 passed this 23rd day of June 1987.

ORIGINALLY SIGNED BY MURRAY HACKETT

ORIGINALLY SIGNED BY E.G. BERGENSTEIN

DIGITAL ZONING MAP	
DATE: April 2020	SCALE: 1:12,500
DRAWN BY: C.T.	CAD FILE: MAP A4
ASSESSMENT MAPPING - April 2020	

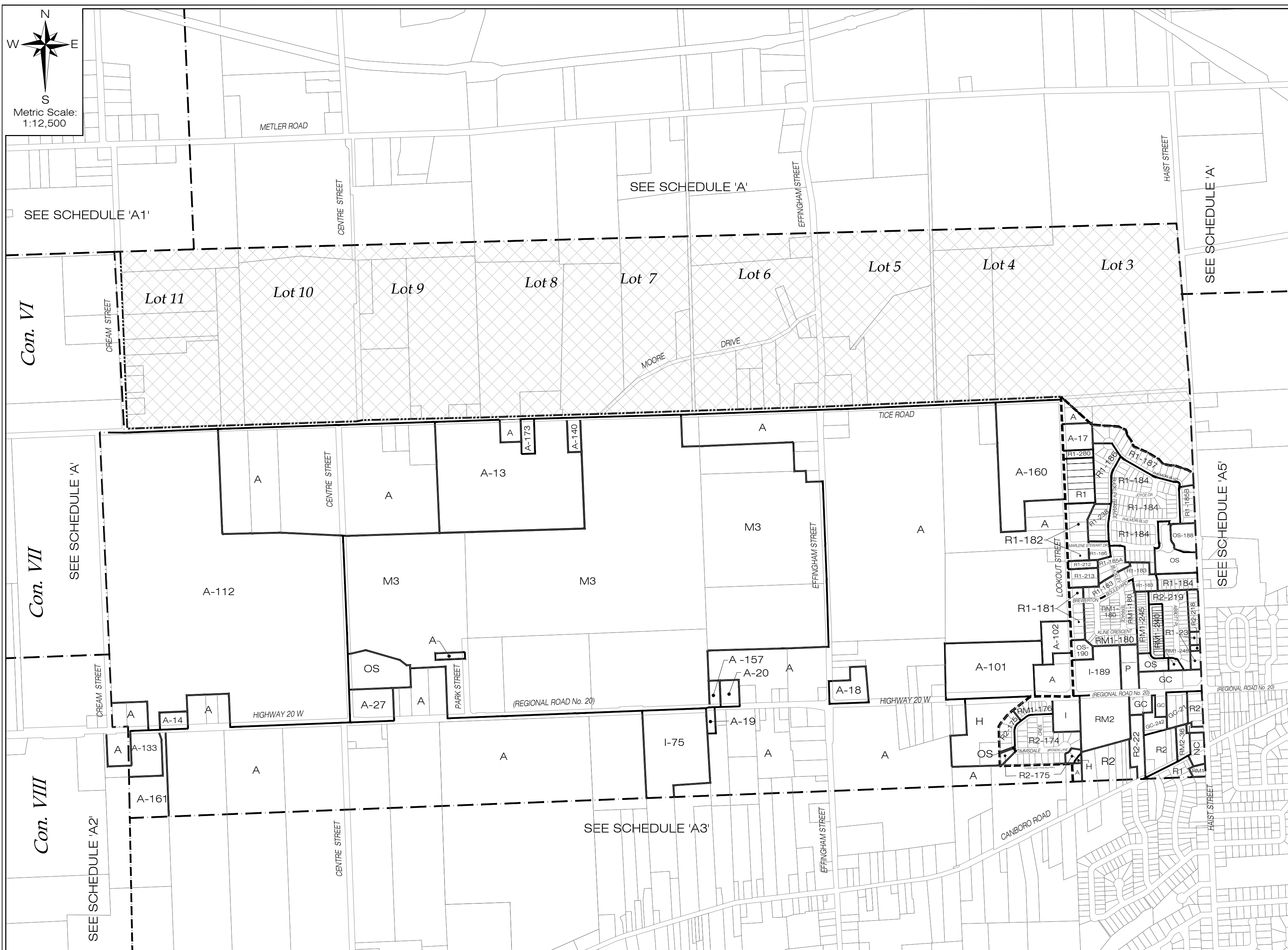

ZONE AMENDMENTS & BY-LAWS TO THE ZONING BY-LAW

• A to A-101 & A-102	1383 (1991)	• A to RM1-180(H), R1-181(H), R1-182(H),	2956 (2008)
• Lands Deleted from the Zoning By-law	1417 (1991)	• R1-183(H), R1-184(H), R1-185(H), R1-186(H),	
• M3 to A-112	1509 (1992)	• R1-187(H), R1-188(H), R1-189(H), I-189(H), OS-190 & OS	OMB Order 1535 (Sep.22/2004)
• A-16 to A-17	1609 (1993)	• RM1-180(H), R1-181(H), R1-182(H), R1-183(H),	
• A to A-133	1820 (1996)	• R1-185(H), R1-186(H) & I-189(H) to RM1-180,	2779 (2006)
• A-13 to A-140	1987 (1998)	• R1-181, R1-182, R1-183, R1-185, R1-186 & I-189	2787 (2006)
• A to M3	2166 (2000)	• A to R2-174, R2-175 & H	2796 (2006)
• A & A-20 to A-157	2215 (2000)	• A to R1-211	2817 (2006)
• A to A-160(H)	2284 (2001)	• A to R1-212 & R1-213	2897 (2007)
• A to A-133 & A-161	2294 (2001)	• A-133 - Additional Uses	
• A-160(H) to A-160	2427 (2002)	• R1-23 & R2(H) to R2-218(H);	2943 (2008)
• A-13 to A-173	2433 (2002)	• R2(H) & RM1-191(H) to R2-219(H);	
• A to R2-174, R2-175, RM1-176, OS & H	2473 (2003)	• RM1-191(H) to R2-219(H)	
• A to R2(H), RM1-191(H), RM1(H) & OS	2619 (2004)		
		• R1-183 & R1-184	
		• R1-183(H), R1-185(H), R1-187(H) & R1-186(H) to R1-184(H);	
		• R1-187(H) to R1-185(H); R1-188(H) & R1-187(H) to R1-186(H);	
		• R1-188(H) to R1-187(H); OS to OS-188; R1-184(H) to OS;	3325 (2012)
		• R1-186(H) to R1-238(H)	
		• R1-184(H), R1-185(H), R1-186(H), R1-187(H) & R1-238(H)	3403 (2013)
		• to R1-184, R1-185, R1-186, R1-187 & R1-238	3409 (2013)
		• RM1-191(H), R2-218(H) & R2-219(H) to RM1-191, R2-218 & R2-219	3428 (2013)
		• R2-219 to RM1-240	3452 (2014)
		• M3 to OS	3472 (2014)
		• GC to GC-242	3511 (2014)
		• RM1 to RM1-245	3909 (2017)
		• R1-211 & A to R1; A to R1-280	