

PART 2
AREA=109m²±

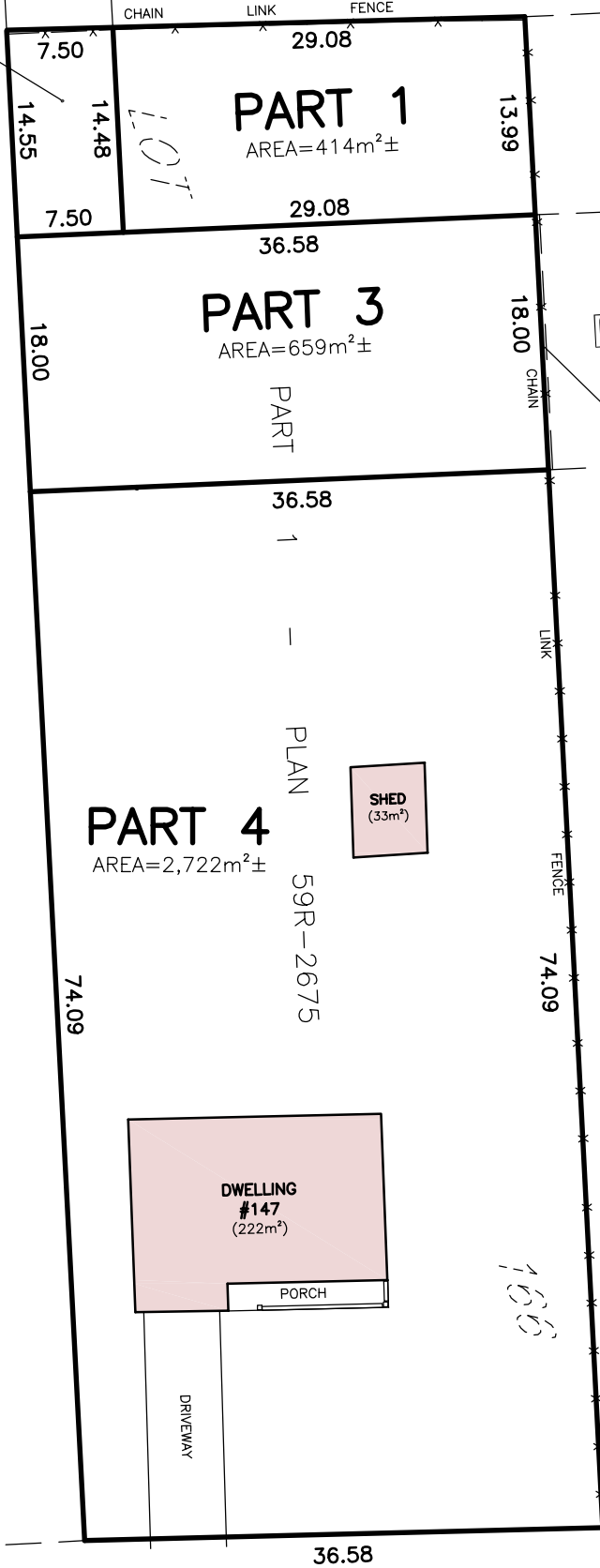

PART 1 - PLAN 59R-15910

22

SUSAN DRIVE
REGISTERED

MOODY STREET
18.00 WIDE

BLOCK 49
(0.3 RESERVE)

PLAN

BLOCK 47

59M-477

BLOCK 48
(0.3 RESERVE)

PORT ROBINSON ROAD
IRREGULAR WIDTH

SUBJECT AND ABUTTING LAND USE - RESIDENTIAL

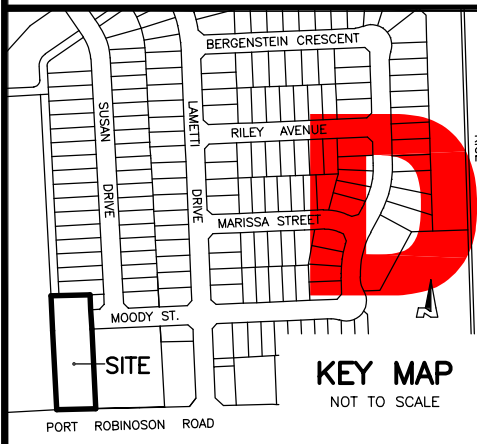

KEY MAP
NOT TO SCALE

SKETCH

PREPARED FOR SEVERANCE APPLICATION

PART OF LOT 166
GEOGRAPHIC TOWNSHIP OF THOROLD
IN THE
TOWN OF PELHAM
REGIONAL MUNICIPALITY OF NIAGARA
SCALE: 1 : 500 (METRIC)

NOTE: THIS SKETCH IS PREPARED FROM COMPILED AND CALCULATED INFORMATION, NOT FROM AN ACTUAL SURVEY.
DO NOT SCALE FROM THIS DRAWING.
ALL MEASUREMENTS ARE +/- MEASUREMENTS.

CAUTION: THIS IS NOT A PLAN OF SURVEY AND SHALL NOT BE USED EXCEPT FOR THE PURPOSE INDICATED IN THE TITLE BLOCK.

"THIS IS NOT AN ORIGINAL COPY UNLESS EMBOSSED WITH SEAL"

© **COPYRIGHT 2021**
THE REPRODUCTION, ALTERATION OR USE OF THIS SKETCH, IN WHOLE OR IN PART WITHOUT THE EXPRESS WRITTEN PERMISSION OF CHAMBERS AND ASSOCIATES SURVEYING LTD. IS STRICTLY PROHIBITED.

DATE _____ DONALD G. CHAMBERS, B. Sc., O.L.S.

CHAMBERS AND ASSOCIATES SURVEYING LTD

12 THOROLD ROAD EAST (905) 735-7841 / 735-7844
WELLAND ONTARIO FAX (905) 735-7333
L3C 3T2 www.casl-surveying.com

DWG **21041_SEV** FILE **21-41**